



# Medium vacuum chamber, vertical, KVG, DN 250

---



**PFEIFFER** 

# Medium vacuum chamber

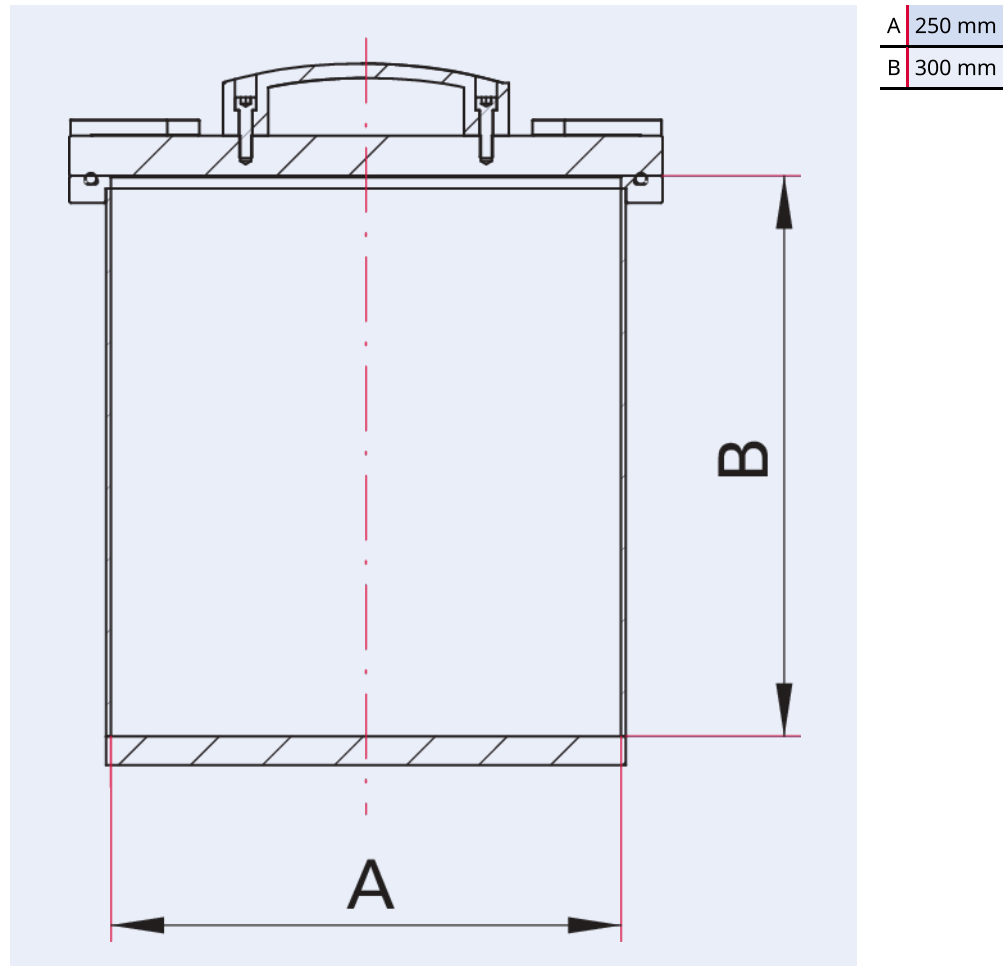

Illustration only

## **Medium vacuum chamber, vertical, KVG, DN 250**

- Cylindrical, vertical body with a welded flat bottom and top flange with FKM seal
- Acrylic glass cover (PMMA) with handles and external guides for easy installation and protection of the sealing surface when put down
- Surface inside and outside glass-bead blasted
- Chamber with mounting straps
- Chamber ports available (accessories)

## Dimensions



Technical Data	Medium vacuum chamber, vertical, KVG, DN 250
Temperature range	0 – 40 °C
Tightness	$<1 \cdot 10^{-9}$ Pa m <sup>3</sup> /s   $<7.5 \cdot 10^{-9}$ Torr l/s   $<1 \cdot 10^{-8}$ mbar l/s
Connection flange	DN 250
Pressure range	$1 \cdot 10^{-5}$ hPa – to ambient pressure
Material	Chamber body made from stainless steel 304 (1.4301), acrylic glass cover (PMMA)
Temperature range max.	40 °C   104 °F   313.15 K
Temperature range min.	0 °C   32 °F   273.15 K

Order number	Medium vacuum chamber, vertical, KVG, DN 250
Medium vacuum chamber, vertical, KVG, DN 250	820KVG250-300

Are you looking for an optimum vacuum solution?  
Talk to us:  
**Pfeiffer Vacuum Components & Solutions GmbH Germany**  
**T +49 551 99963-0**  
**info-cs@pfeiffer-vacuum.com**

Or scan the barcode, to visit our web page:



<https://webportal.pfeiffer-vacuum.com/global/en/contact>



Errors and/or changes excepted. - 5/14/2025

Follow Us On Social Media  
#pfeiffervacuum



[www.pfeiffer-vacuum.com](http://www.pfeiffer-vacuum.com)

**PFEIFFER** 