



**Ball valve, manually  
actuated, brass, nickel-  
plated, DN 16 ISO-KF**

---



**PFEIFFER** 

# Ball valve

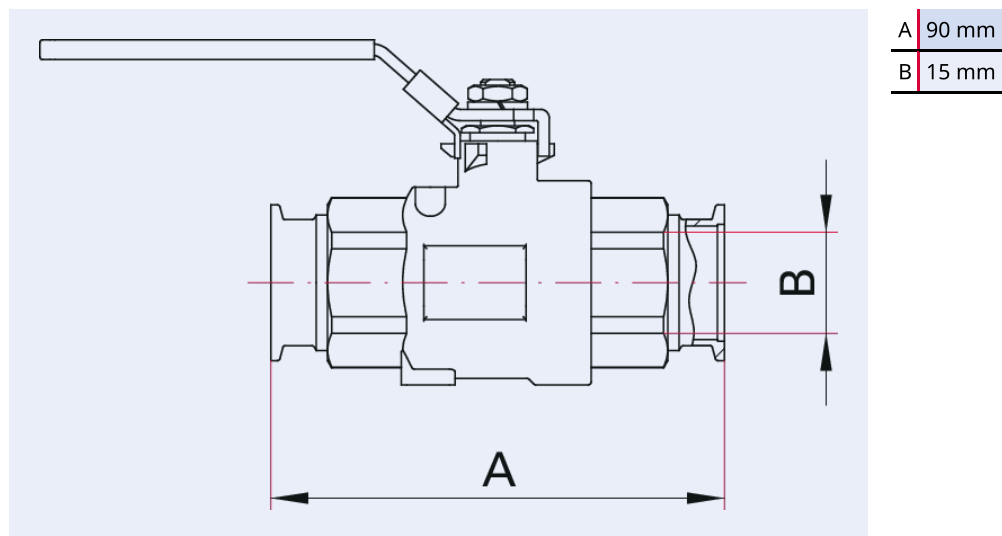

Illustration only

## Ball valve, manually actuated, brass, nickel-plated, DN 16 ISO-KF

- Ball valve with large-scale free clearance
- Ball made from brass, hard-chrome plated

## Dimensions



Technical Data	Ball valve, manually actuated, brass, nickel-plated, DN 16 ISO-KF
Flange, material	Stainless steel 1.4301 (AISI 304)
Seal	Ball: PTFE (reinforced with fiberglass)   Stem: PTFE/FKM
Type	Ball valve
Temperature range	20 – 80 °C
Housing	Brass, nickel-plated
Actuator	90° rotation of hand lever
Tightness	$<1 \cdot 10^{-7}$ Pa m <sup>3</sup> /s   $<7.5 \cdot 10^{-7}$ Torr l/s   $<1 \cdot 10^{-6}$ mbar l/s
Weight approx.	0.31 kg   0.68 lb
Connection flange	DN 16 ISO-KF
Pressure range	$1 \cdot 10^{-5}$ hPa – $5 \cdot 10^2$ hPa over pressure
Temperature range max.	80 °C   176 °F   353.15 K
Temperature range min.	20 °C   4 °F   253.15 K

Order number	Ball valve, manually actuated, brass, nickel-plated, DN 16 ISO-KF
Ball valve, manually actuated, brass, nickel-plated, DN 16 ISO-KF	140VKZ016

Are you looking for an optimum vacuum solution?  
Talk to us:  
**Pfeiffer Vacuum Components & Solutions GmbH Germany**  
**T +49 551 99963-0**  
**info-cs@pfeiffer-vacuum.com**

Or scan the barcode, to visit our web page:



<https://webportal.pfeiffer-vacuum.com/global/en/contact>



Errors and/or changes excepted. - 5/14/2025

Follow Us On Social Media  
#pfeiffervacuum



[www.pfeiffer-vacuum.com](http://www.pfeiffer-vacuum.com)

**PFEIFFER** 