



PFEIFFER 

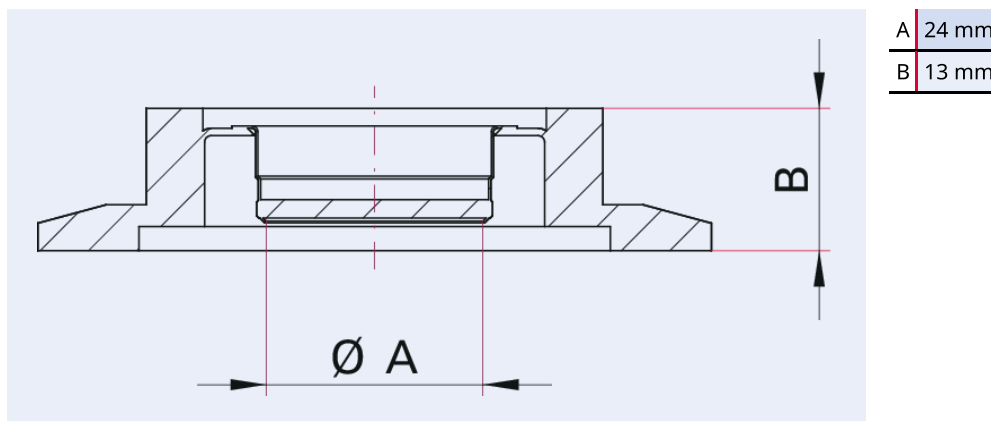

Illustration only

Viewport, stainless steel / sapphire glass, DN 40 ISO-KF

- Stainless steel frame; glass soldered
- Transmission in IR spectrum to 4500 nm
- Caution! Risk of injury by glass splinters. Do not use viewports which show apparent damage

Dimensions



| Technical Data | Viewport, stainless steel / sapphire glass, DN 40 ISO-KF |
|----------------------------|---|
| Flange, material | Stainless steel |
| Temperature range | 100 – 350 °C |
| Sight glass | Sapphire glass |
| Heat up and cool down rate | ≤20 K/min |
| Connection flange | DN 40 ISO-KF |
| Pressure range | $1 \cdot 10^{-8}$ hPa – $5 \cdot 10^2$ hPa over pressure |
| Temperature range max. | 350 °C 662 °F 623.15 K |
| Temperature range min. | 100 °C 148 °F 173.15 K |

| Order number | Viewport, stainless steel / sapphire glass, DN 40 ISO-KF |
|---|---|
| Viewport, stainless steel / sapphire glass, DN 40 ISO-KF | 120GSG040-saphir |

Are you looking for an optimum vacuum solution?
Talk to us:
Pfeiffer Vacuum Components & Solutions GmbH Germany
T +49 551 99963-0
info-cs@pfeiffer-vacuum.com

Or scan the barcode, to visit our web page:



<https://webportal.pfeiffer-vacuum.com/global/en/contact>



Errors and/or changes excepted. - 5/14/2025

Follow Us On Social Media
#pfeiffervacuum



www.pfeiffer-vacuum.com

PFEIFFER 