



**Butterfly valve,
manually operated,
DN 25 ISO-KF,
aluminum**



PFEIFFER 

Butterfly Valve

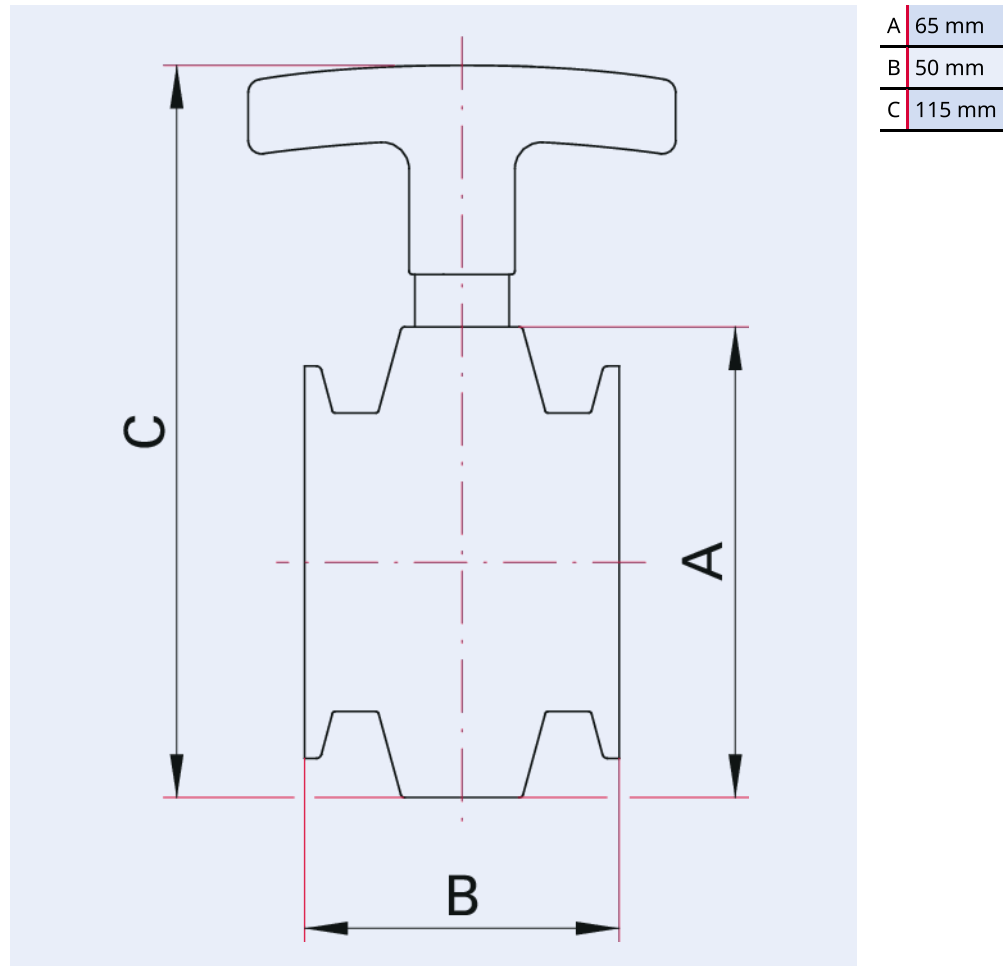

Illustration only

Butterfly valve, manually operated, DN 25 ISO-KF, aluminum

- Swivel valve plate with FKM seal
- Valve position indicated by T-handle
- Nearly free clearance in open position
- In the open position, the valve disc does not protrude from the valve
- Double valve head seal made from FKM
- Service life: 3000 operating cycles

Dimensions



Technical Data	Butterfly valve, manually operated, DN 25 ISO-KF, aluminum
Seal	FKM
Type	Butterfly valve
Temperature range	15 – 130 °C
Housing	Aluminum
Actuator	Manual
Tightness	1 · 10 ⁻¹⁰ Pa m ³ /s 7.5 · 10 ⁻¹⁰ Torr l/s 1 · 10 ⁻⁹ mbar l/s
Connection flange	DN 25 ISO-KF
Pressure range	1 · 10 ⁻⁸ hPa – to ambient pressure
Temperature range max.	130 °C 266 °F 403.15 K
Temperature range min.	15 °C 5 °F 258.15 K

Order number	Butterfly valve, manually operated, DN 25 ISO-KF, aluminum
Butterfly valve, manually operated, DN 25 ISO-KF, aluminum	110VSM025.A

Are you looking for an optimum vacuum solution?
Talk to us:
Pfeiffer Vacuum Components & Solutions GmbH Germany
T +49 551 99963-0
info-cs@pfeiffer-vacuum.com

Or scan the barcode, to visit our web page:



<https://webportal.pfeiffer-vacuum.com/global/en/contact>



Errors and/or changes excepted. - 5/14/2025

Follow Us On Social Media
#pfeiffervacuum



www.pfeiffer-vacuum.com

PFEIFFER 