



A large, modern industrial building at dusk, illuminated by bright lights, with a dark sky and a paved foreground. The building features a complex, multi-level design with various sections and a prominent entrance area. The sky is a deep blue with some clouds, and the foreground is a dark, paved area. The building's lights create a strong contrast with the dark sky and foreground.



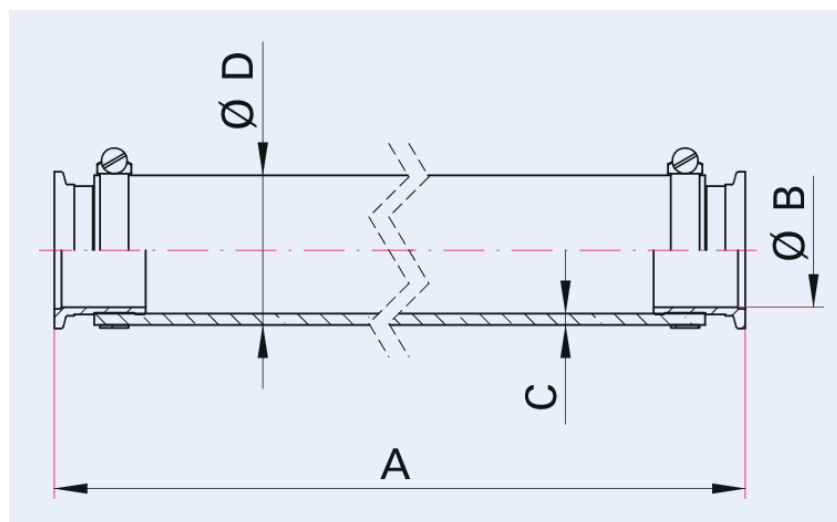

Illustration only

PVC hose with embedded spring and flanges, PVC with stainless steel flange, 304/1.4301, DN 50

- Inner tube: PVC, transparent
- Casing: Steel coil
- Hose cover: PVC, transparent
- Smooth inner and outer walls
- Custom lengths on request

Dimensions



A	500 mm
B	45 mm
C	5 mm
D	61 mm

Technical Data	PVC hose with embedded spring and flanges, PVC with stainless steel flange, 304/1.4301, DN 50
Materials in contact with media	PVC Flange: Stainless steel
Temperature range	5 – 40 °C
Bending radius	195 mm 7.68 inch
Connection flange	DN 50 ISO-KF
Pressure range	1 · 10 ⁻⁴ hPa – to ambient pressure
Material	PVC
Temperature range max.	40 °C 104 °F 313.15 K
Temperature range min.	5 °C 23 °F 268.15 K

Order number	PVC hose with embedded spring and flanges, PVC with stainless steel flange, 304/1.4301, DN 50
PVC hose with embedded spring and flanges, PVC with stainless steel flange, 304/1.4301, DN 50	100SPA050-0500.A

Are you looking for an optimum vacuum solution?
Talk to us:
Pfeiffer Vacuum Components & Solutions GmbH Germany
T +49 551 99963-0
info-cs@pfeiffer-vacuum.com

Or scan the barcode, to visit our web page:



<https://webportal.pfeiffer-vacuum.com/global/en/contact>



Errors and/or changes excepted. - 5/14/2025

Follow Us On Social Media
#pfeiffervacuum



www.pfeiffer-vacuum.com

PFEIFFER 