



Rotary feedthrough, DN 25 ISO-KF



Rotary feedthrough, elastomer-sealed

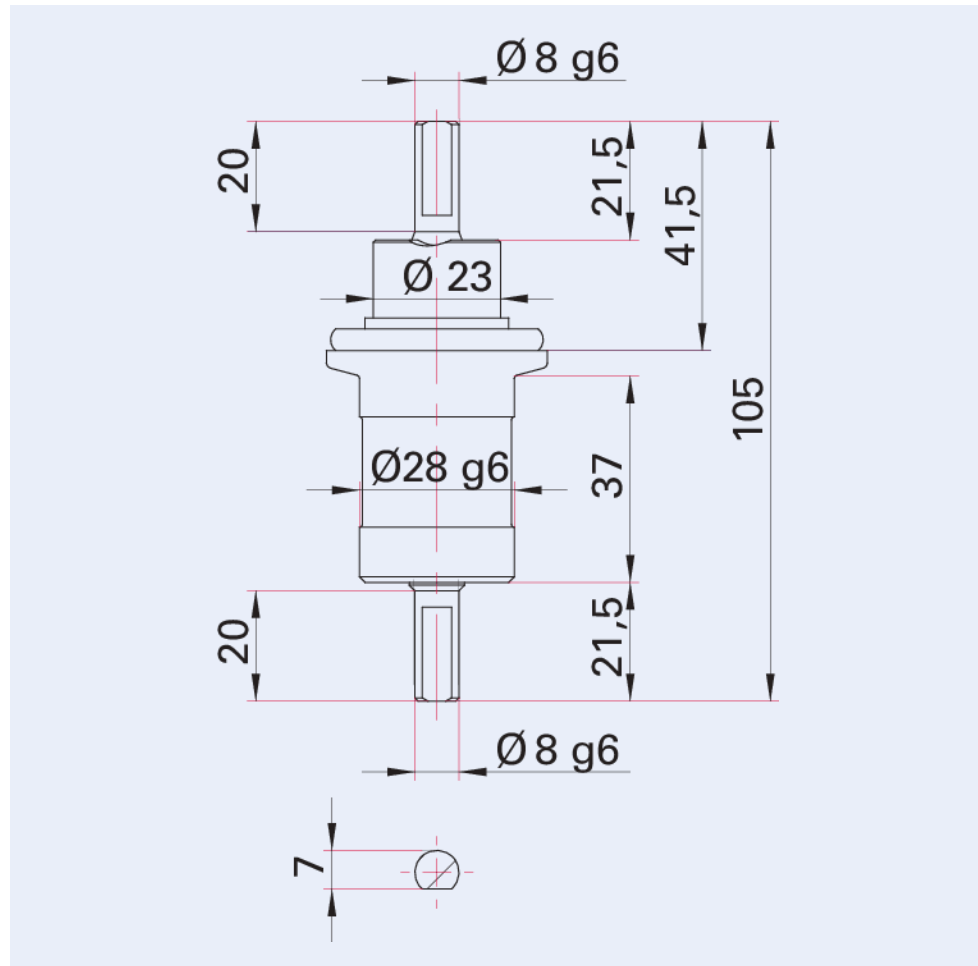

Illustration only

Rotary feedthrough, DN 25 ISO-KF

- Hardened shaft made of stainless steel
- With FKM shaft seal and ball bearing, greased to be suitable for vacuum
- The rotation speed can be increased by up to a factor of two if reduced service life is acceptable
- With through shaft for directly transmitting high torques
- With integrated FKM O-ring, installation without additional seal
- Tightness static: 1×10^{-9} mbar l/s
- Tightness dynamic: 1×10^{-9} mbar l/s to 5×10^{-7} mbar l/s
- When designing a rotary drive, take care that the rotary feedthrough is not the weakest component of the assembly
- Inadmissible loads damage the rotary feedthrough
- Do not apply force when sliding the coupling piece over the shaft. Consider the admissible levels of axial and radial force.

Dimensions



Technical Data

Rotary feedthrough, DN 25 ISO-KF

Seal	FKM
O-ring material	FKM
Transferred torque	6 N m
Operating temperature	$\leq 50 \text{ °C}$
Mounting orientation	Arbitrary
Tightness (static)	$1 \cdot 10^{-10} \text{ Pa m}^3/\text{s}$ $7.5 \cdot 10^{-10} \text{ Torr l/s}$ $1 \cdot 10^{-9} \text{ mbar l/s}$
Weight approx.	0.2 kg 0.44 lb
Rotation speed	$\leq 1000 \text{ rpm}$
Shaft load, radial	150 N
Shaft load, axial	50 N
Shaft connection	$\text{Ø } 8 \text{ mm}$
Connection flange	DN 25 ISO-KF
Pressure range	$1 \cdot 10^{-8} \text{ hPa}$ – to ambient pressure
Material	Housing: aluminum; shaft: stainless steel

Order number	Rotary feedthrough, DN 25 ISO-KF
Rotary feedthrough, DN 25 ISO-KF	120MRD025



Errors and/or changes excepted. - 5/15/2025

Are you looking for an optimum vacuum solution?

Talk to us:

Pfeiffer Vacuum Components & Solutions GmbH Germany

T +49 551 99963-0

info-cs@pfeiffer-vacuum.com

Or scan the barcode, to visit our web page:



<https://webportal.pfeiffer-vacuum.com/global/en/contact>

Follow Us On Social Media

#pfeiffervacuum



www.pfeiffer-vacuum.com

PFEIFFER 