



**Glass flange,  
borosilicate, DN 25 ISO-  
KF**

---

**PFEIFFER** 

# Glass blank flange

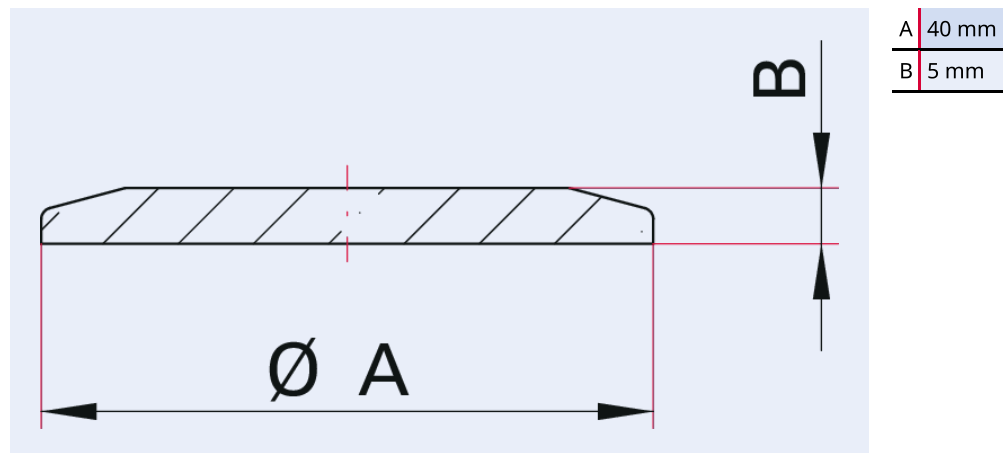

Illustration only

## Glass flange, borosilicate, DN 25 ISO-KF

- Installation with outer centering ring and elastomer seal
- Fastening elements: Clamping ring made from plastic (no usage of metal connection elements)
- Caution! Risk of injury by glass splinters. Do not use viewports which show apparent damage

## Dimensions



## Technical Data

Technical Data	Glass flange, borosilicate, DN 25 ISO-KF
Materials in contact with media	Borosilicate glass
Temperature range	15 – 150 °C
Heat up and cool down rate	≤5 K/min
Connection flange	DN 25 ISO-KF
Pressure range	1 · 10 <sup>-8</sup> hPa – 5 · 10 <sup>2</sup> hPa over pressure
Temperature range max.	150 °C   302 °F   423.15 K
Temperature range min.	15 °C   59 °F   288.15 K

<b>Order number</b>	<b>Glass flange, borosilicate, DN 25 ISO-KF</b>
Glass flange, borosilicate, DN 25 ISO-KF	160FBL025



Errors and/or changes excepted. - 5/14/2025

Are you looking for an optimum vacuum solution?

Talk to us:

**Pfeiffer Vacuum Components & Solutions GmbH Germany**

**T +49 551 99963-0**

**info-cs@pfeiffer-vacuum.com**

Or scan the barcode, to visit our web page:



<https://webportal.pfeiffer-vacuum.com/global/en/contact>

Follow Us On Social Media

#pfeiffervacuum



[www.pfeiffer-vacuum.com](http://www.pfeiffer-vacuum.com)

**PFEIFFER** 